

* DISCUSS LOCATION OF BACKSLOPE SWALE IN RELATION TO UE & LOT LINE

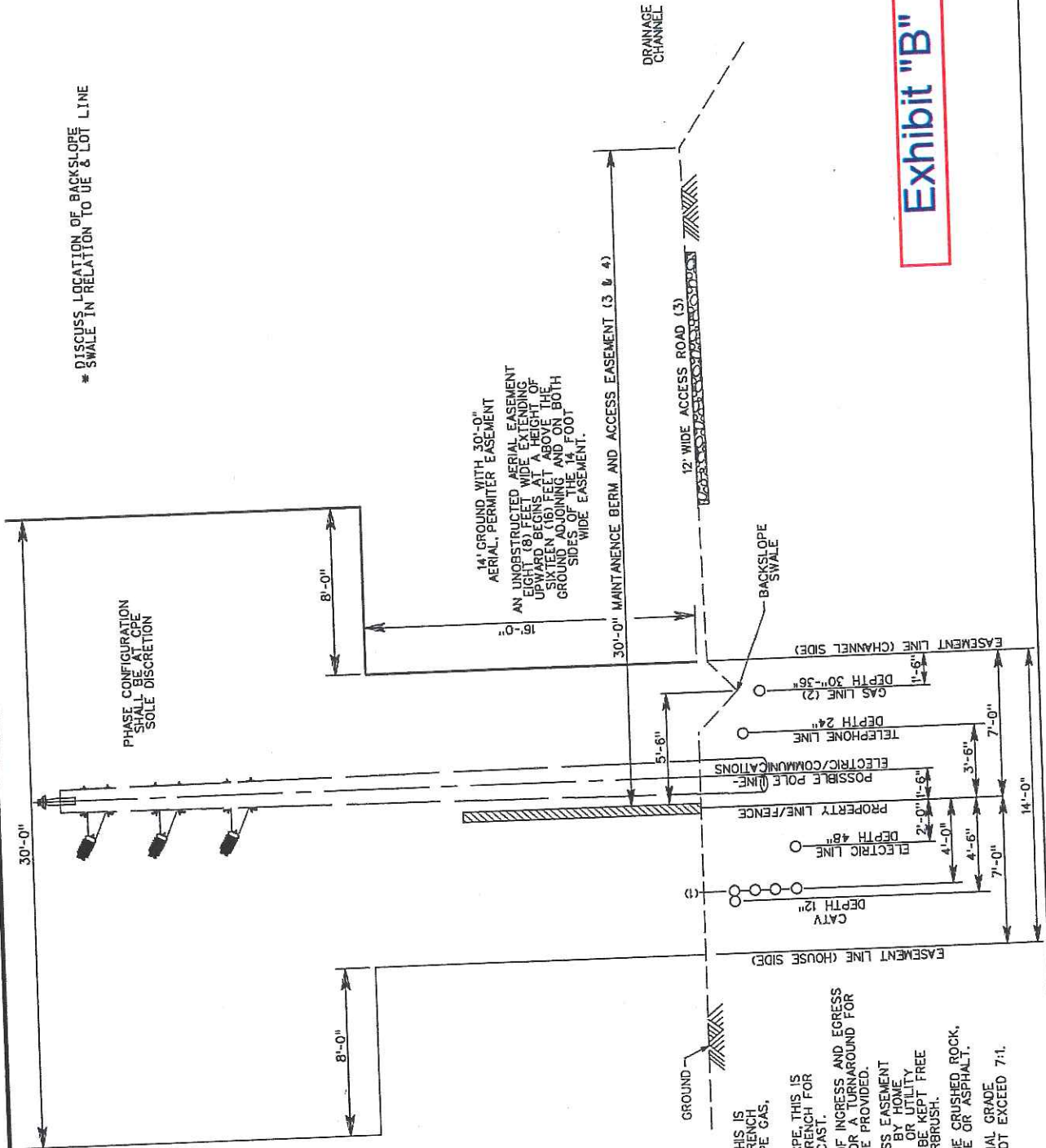

PHASE CONFIGURATION SHALL BE AT CPE SOLE DISCRETION

14'-0" GROUND WITH 30'-0" AERIAL PERMITTER EASEMENT
 AN UNOBSTRUCTED AERIAL EASEMENT EIGHT (8) FEET WIDE EXTENDING UPWARD BEGINS AT A HEIGHT OF SIXTEEN (16) INCHES AND ON BOTH SIDES OF THE 14 FOOT WIDE EASEMENT.

30'-0" MAINTENANCE BERM AND ACCESS EASEMENT (3 & 4)

DRAINAGE CHANNEL

12' WIDE ACCESS ROAD (3)

BACKSLOPE SWALE

EASEMENT LINE (CHANNEL SIDE)

DEPTH 30"-36"

GAS LINE (2)

DEPTH 24"

TELEPHONE LINE

POSSIBLE POLE LINE

PROPERTY LINE/FENCE

DEPTH 48"

ELECTRIC LINE

DEPTH 12"

CATV

DEPTH 12"

7'-0"

4'-6"

3'-6"

7'-0"

EASEMENT LINE (HOUSE SIDE)

14'-0"

- (1) IF ELECTRIC IS CPE THIS IS LOCATION OF JOINT TRENCH FOR CPE GAS, ATT & COMCAST.
- (2) IF ELECTRIC IS NOT CPE, THIS IS LOCATION OF JOINT TRENCH FOR CPE GAS, ATT & COMCAST.
- (3) A SEPARATE MEANS OF INGRESS AND EGRESS SHALL BE PROVIDED OR A TURNAROUND FOR A 50' TRUCK SHALL BE PROVIDED.
- (4) UNOBSTRUCTED ACCESS EASEMENT SHALL BE MAINTAINED BY HOME OWNERS ASSOCIATION OR UTILITY DISTRICT AND SHALL BE KEPT FREE OF TREES AND UNDERBRUSH.
- (5) ACCESS ROAD MAY BE CRUSHED ROCK, BULL ROCK, CONCRETE OR ASPHALT.
- (6) CROSS-SLOPE OF FINAL GRADE ACROSS UE SHALL NOT EXCEED 7:1.

Exhibit "B"